

PROPOSED PROJECT AT MAHALLA-KANAINATSHAL, ON MOUZA-KANAINATSHAL, J.L. NO-76, C.S. PLOT NO-211, C.S. KHATIAN NO-166, R.S, PLOT NO-211/666, R.S. KHATIAN NO-183, L.R. PLOT NO-211/666 & 211/774, L.R. KHATIAN NO-2855, HOLDING NO-95/14, WARD NO-12, UNDER BURDWAN MUNICIPALITY, P.S.-BARDHAMAN, DISTRICT-PURBA BARDHAMAN

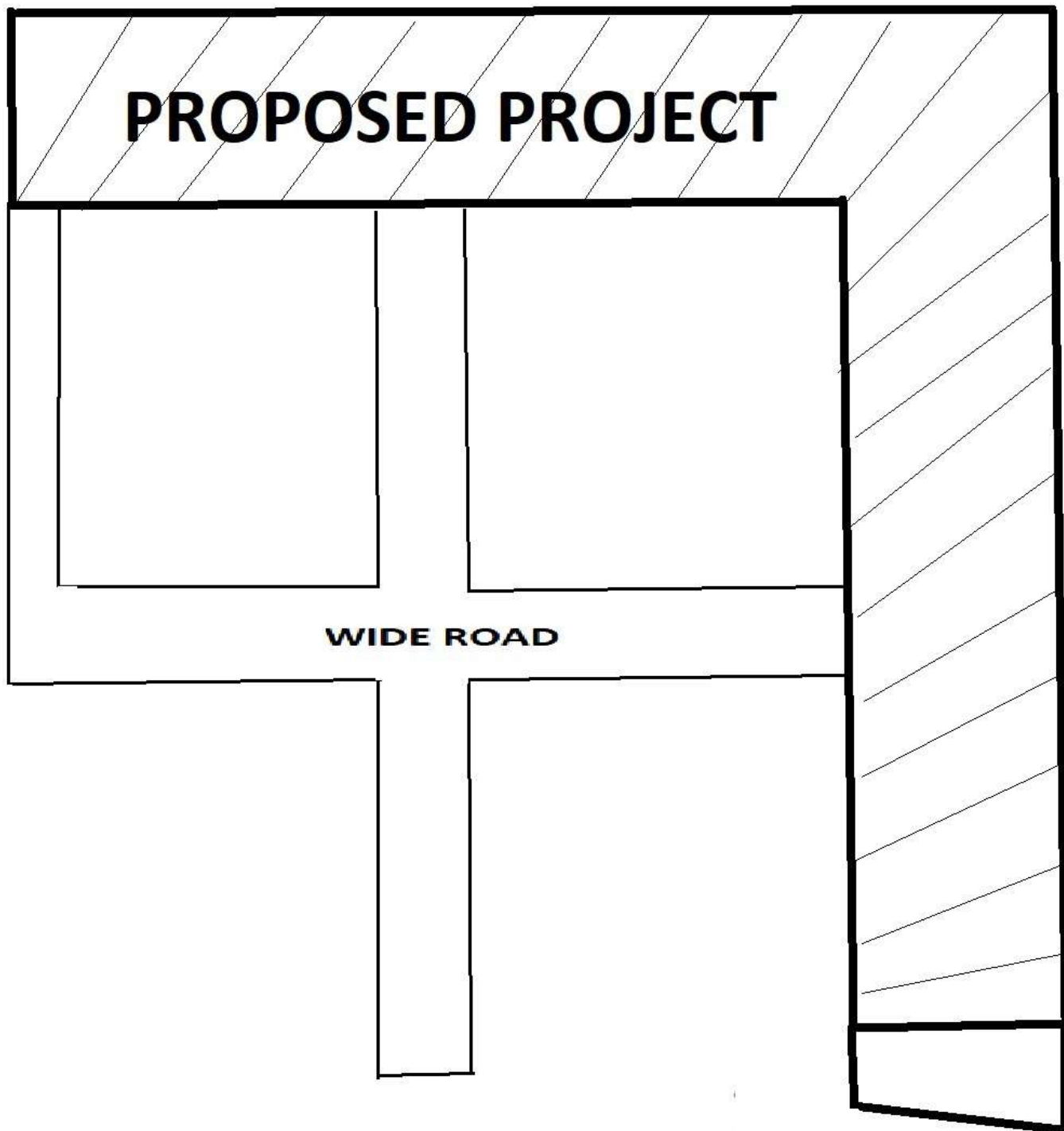

LATITUDE : 23.219716
LONGITUDE : 87.879653

For BARDDHAMAN HOUSING
DEVELOPMENT (P) LTD.

Sintalihar
Director

SIGNATURE OF OWNER